

Dal 1960 al servizio dello **SPORT**



**SCHIAVI** **SPORT**

**CATALOGO 2020-2021**

## WALL PROTECTIONS | EDGE AND ANGLE PROTECTIONS

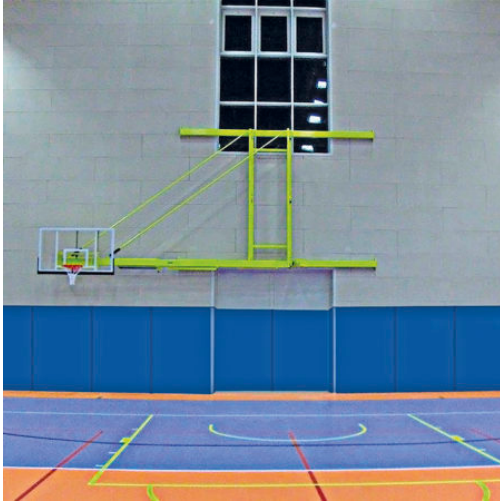

### ART. 3850 PADDED PROTECTION FOR WALLS AND PILLARS

ART. 3850 PADDED PROTECTION FOR WALLS AND PILLARS  
 Mattress in nondeformable closed cell foam fire reaction class 1, density D 35 (35 kg./m<sup>3</sup>) 2,5 cm. thick, shock absorption according to EN 913C, NAIZIL cover fabric reaction to fire class 1, blue or yellow, washable, anti-bacterial, anti-mold, prepared for wall mounting with band with button-hole and dowels (dowels not provided), or velcro - size on request - ask for quote.

#### QUOTE ON REQUEST

**Categories:** [MATTRESSES](#) | [MAT](#) | [WALL PROTECTIONS](#), [WALL PROTECTIONS](#) | [EDGE AND ANGLE PROTECTIONS](#)

### ART. 3857ABLU BLUE WALL PROTECTION

Blue wall protection 24 mm. thick, fire reaction class 1. Soft and compact foam to ensure shock absorption, non-toxic, washable coated with scratch-resistant material, to be glued to walls, columns, edges and corners (use special glue - 300 gr. x sq.m.) size 200x145x2,4 cm., blue, in accordance to EN 913C - EN 1177:2008.

**Categories:** [MATTRESSES](#) | [MAT](#) | [WALL PROTECTIONS](#), [WALL PROTECTIONS](#) | [EDGE AND ANGLE PROTECTIONS](#)





## ART. 3857ABLU-H 220 BLUE WALL PROTECTION

Blue wall protection 24 mm. thick, fire reaction class 1. Soft and compact foam to ensure shock absorption, non-toxic, washable coated with scratch-resistant material, to be glued to walls, columns, edges and corners (use special glue - 300 gr. x sq.m.) size 220x145x2,4 cm., blue, in accordance to EN 913C - EN 1177:2008.

**Categories:** [MATTRESSES](#) | [MAT](#) | [WALL PROTECTIONS](#), [WALL PROTECTIONS](#) | [EDGE AND ANGLE PROTECTIONS](#)

## ART. 3858BL "Z" FINISHING BLUE

ART. 3858BL "Z" FINISHING BLUE  
204 cm., blue, to finish start/end and top Art 3857BLU - to apply with special glue or dowels.

**Categories:** [MATTRESSES](#) | [MAT](#) | [WALL PROTECTIONS](#), [WALL PROTECTIONS](#) | [EDGE AND ANGLE PROTECTIONS](#)

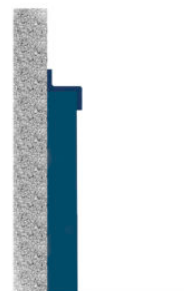

## ART. 3856BL SOFT ANGLED EDGE PROTECTION BLUE

In soft foam for shock absorption, soft, non-toxic, reaction to fire class 1, coated with scratch-resistant material, washable (to be fixed with special glue) size 200hx5x5 cm. 22 mm. thick, blue, according to EN 913C.

**Categories:** [MATTRESSES](#) | [MAT](#) | [WALL PROTECTIONS](#), [WALL PROTECTIONS](#) | [EDGE AND ANGLE PROTECTIONS](#)

## ART. 3870 SPECIAL GLUE

ART. 3870 SPECIAL GLUE

### ART. 3870 - 1

SPECIAL GLUE 1 1kg. to glue corner guards and wall protections TR to the walls, to be applied by brush or roller on the wall and on the protection 0,850 kg. (yeld: 150 gr. wall 150 gr. protection = 300 gr. x 1sq.m.)

### ART. 3870 - 4

SPECIAL GLUE 4 4 kg. (yeld: 150 gr. wall 150 gr. protection = 300 gr. x 1sq.m.)

### ART. 3870 - 10

SPECIAL GLUE 10 10 kg. (yeld: 150 gr. wall 150 gr. protection = 300 gr. x 1sq.m.)

**Categories:** [MATTRESSES](#) | [MAT](#) | [WALL PROTECTIONS](#),  
[WALL PROTECTIONS](#) | [EDGE AND ANGLE PROTECTIONS](#)

